

DUNHAM SURVEYING, S.C.
SURVEYING & SUBDIVIDING
DELAVER, WISCONSIN 53115

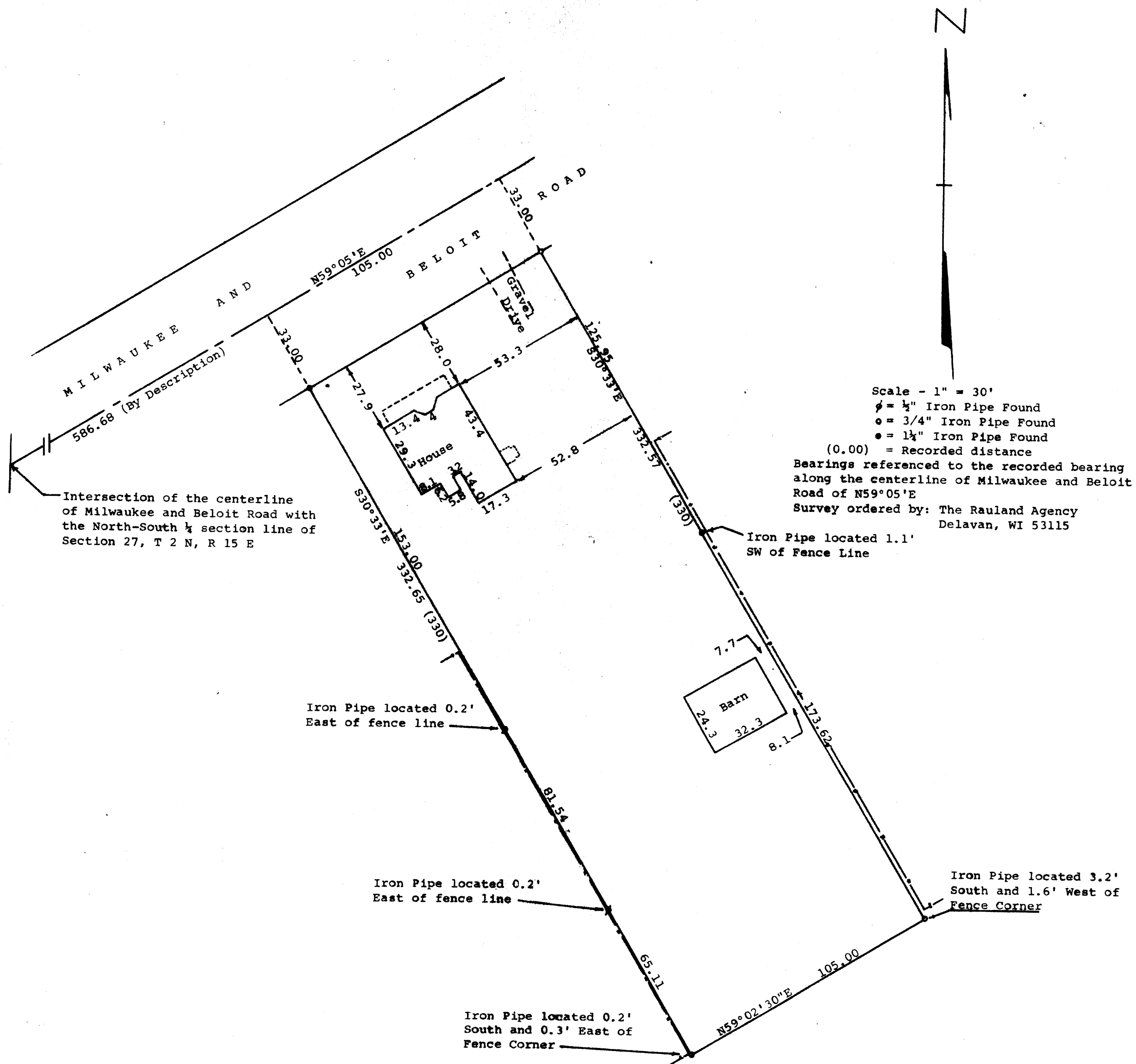

STATE OF WISCONSIN) SS
COUNTY OF WALWORTH)

I, George T. Dunham, Surveyor, certify that I have surveyed the property described as follows:

A parcel of land located in the Southeast 1/4 of Section 27, T 2 N, R 15 E, Village of Darien, Walworth County, Wisconsin, described as follows: Beginning at a point in the center of the Milwaukee and Beloit Road described as being located N59°05'E, 586.68 feet from a point where the 1/4 line running North and South through the center of said Section 27 crosses the center of said Milwaukee and Beloit Road; thence S30°33'E 332.65 feet to the northwesterly line of "Pleasant Manor" a subdivision located in said Southeast 1/4 of Section 27; thence N59°02'30"E along said subdivision, 105.00 feet; thence N30°33'W 332.57 feet to the centerline of the Milwaukee and Beloit Road; thence S59°05'W along said centerline 105.00 feet to the place of beginning,

and that the above map is a true representation thereof and shows the size and location of the property, its exterior boundaries, the location of all visible structures and dimensions of all principal buildings thereon, boundary fences, apparent easements, roadways and visible encroachments, if any, and that I have surveyed the property hereon described according to the official records to the best of my knowledge and belief.
December 2, 1983

George T. Dunham
George T. Dunham, Surveyor

